

Note: The extent of survey information indicated on this drawing is commensurate with use for planning purposes

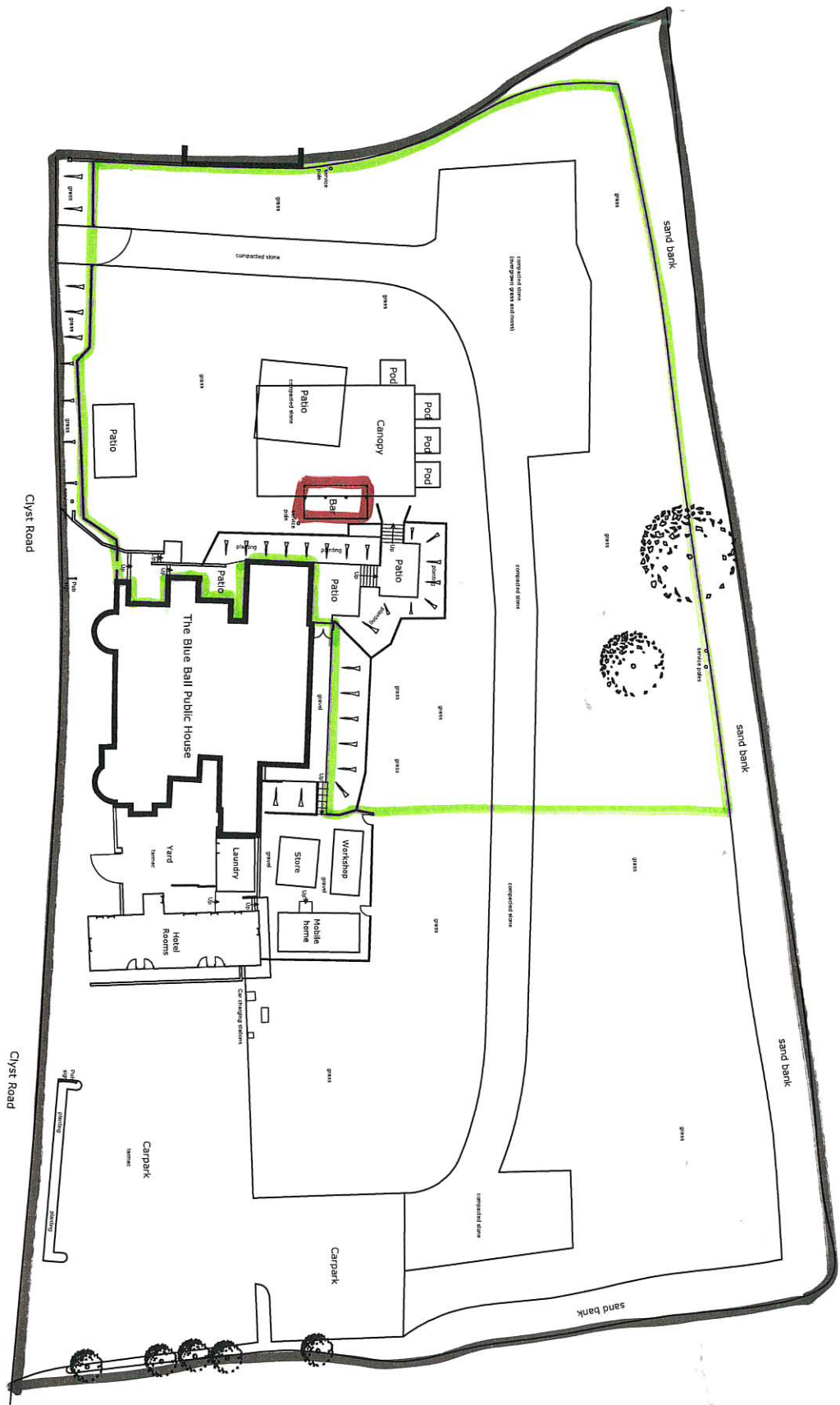

- █ SALE OF ALCOHOL
- █ CONSUMPTION OF ALCOHOL
- █ PERIMETER OF SITE

REF. NO.	ADMINISTRATOR	DATE

**Whickham Architecture Ltd**  
 REGISTERED ARCHITECTS  
 14, CLYDE ROAD, SANDYGATE, EXETER, EX2 7JL  
 E MAIL: micha@whickham.co.uk

**PROJECT:**  
 The Blue Ball, Sandygate, Exeter, EX2 7JL.

**TITLE:**  
 Existing Site Plan

**CLIENT:**  
 St Austell Brewery

**DRAWING NO.:** 23/20/01 **REV. NO.:**

**SCALE:** 1:200 @ A1 **DATE:** January 2021

All dimensions to be checked and given to contractor.